

VIDEO COMMUNICATION SYSTEM PCS-G50

Quick Connection Guide Using Speed Dial

For details on operations, refer to the Operating Instructions

To begin with

Turn on your Video Communication System and TV monitor, and check the following to ensure that connection is possible



① Is the picture of your camera (local picture) on the monitor screen?

Note: Connection to a remote party is not possible if neither the IP address nor ISDN indicator is displayed.

② Select "Information" and press PUSH ENTER

③ When using the LAN
Is the LAN indicator highlighted and is the IP address displayed?



③ When using the ISDN
Are one or more ports of the ISDN indicator highlighted?

Main indicators that appear during communication

	Controlling a remote camera
	Local microphone is turned off
	Sending a still image
	Receiving a still image
	Sending or receiving a computer screen
	Sending or receiving data from a whiteboard

After checking...

Let's connect

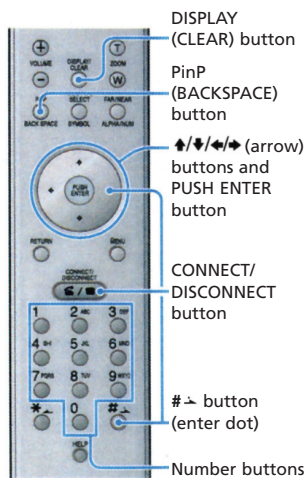

1 Verify the "LINE I/F".

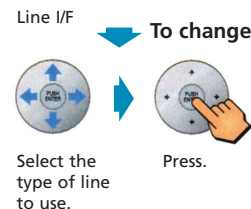

2 Select the Number text box and press PUSH ENTER.

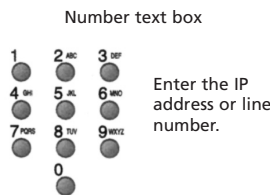

3 Select "Dial" and press PUSH ENTER.



Or Press

4 The system dials and establishes communication.



QUICK REFERENCE GUIDE

Remote Commander® Unit Guide: Operations available during communication

For details on operations, refer to the Operating Instructions

Switching the picture on the TV monitor

Each press of DISPLAY switches the picture.

- Picture from remote
- DISPLAY button
- Still image transmitted or received
- RGB picture
- Picture on a whiteboard

Note: You can switch among the available pictures only.

Switching on/off the local microphone

Adjusting the sound of the remote party

- To increase the volume
- To decrease the volume

Changing the location of the window picture

Each press of PinP changes the location of the window.

No window

Adjusting the camera angle

Up, Down, Left, Right

Using convenient functions

A sub-menu opens to enable sending of still images, etc.

Adjusting the camera zoom

- To enlarge the picture
- To reduce the picture

Selecting the displayed picture and the camera

Display: Select the "Near" or "Far" picture to be displayed on the monitor screen.
Control: Select the "Near Camera" or "Far Camera" to be controlled.

Selecting the input picture

Select the "Near" (local) picture and the "Far" (remote) picture.

MAIN CAMERA: Selects the video from the MAIN CAMERA.
Aux 1: Selects the video from the device connected to the AUX IN connector.
IR1: Selects the video from the optional PCS-D5150 Document Stand.

Displaying the menu available during communication

Ending the conference

Presetting the camera angle

Press button 1 to 6 quickly to move the camera to the preset position. Hold down button 1 to 6 to preset the current camera position.

Note: If you press button 1 to 6 quickly when there is no preset setting, the camera moves to the center position.